

ONE-PHASE MOTORS FOR VOLTAGE REGULATION Series SSg90

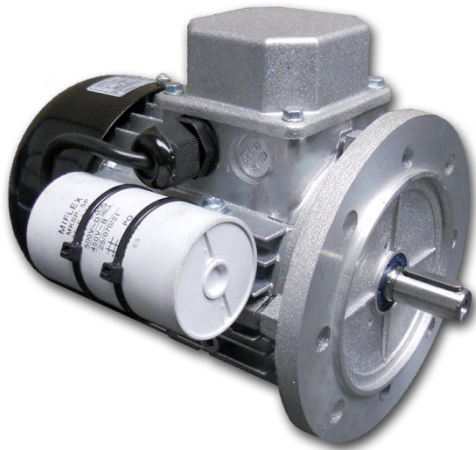

General technical date:

- Single phases induction motors
- Frame size 90
- Rated voltage 230V / 50Hz
- Full temperature protection: bimetallic sensor in stand Winding
- Duty S1 (continuous work)
- Insulation class F
- Degree of protection IP54 (to IP55 on request)
- Work in moderate climate conditions (ambient temperature from -15°C to +40°C)
- Aluminium frame
- Motors meet requirements of EN 60034-1
- CE certificate

Silniki 2-biegunowe (3000 min⁻¹) i 4-biegunowe (1500 min⁻¹)

Type	Rated Output P ₂ [kW]	Rated speed ω [min ⁻¹]	Rated current at 230 V I _N [A]	Rel. pull-in current I _R /I _N	Rated torque M _N [Nm]	Rel. starting torque M _R /M _N	Capacitor C [μF]	Power factor cos φ	Efficiency η [%]
SSg90-2S	1,1	2820	6,90	3,25	3,73	0,55	90	0,97	72
SSg90-2L	1,5	2850	9,40	4,00	5,03	0,48	140	0,99	73
SSg90-4S	0,75	1420	4,60	3,10	5,04	0,44	80	0,96	76
SSg90-4L	1,1	1430	6,50	3,41	7,35	0,58	120	0,99	74

6-poles Motors (1000 rpm) and 8-poles Motors (750 rpm) – on request

Single-phase induction motors of the SSg series are intended for the drive of loads, in which the increase of the motor load takes place along with the square of its rotational speed. This is called fan load characteristic $M_o = f(\omega^2)$, occurring in axial and radial fans and other types of devices for continuous transport of gases or liquids.

Due to the continuous development of the product, the manufacturer reserves the right to introduce changes and modifications to the technical data without prior notice





**Dimensional drawing – feet mounting SSg90
IMB3**

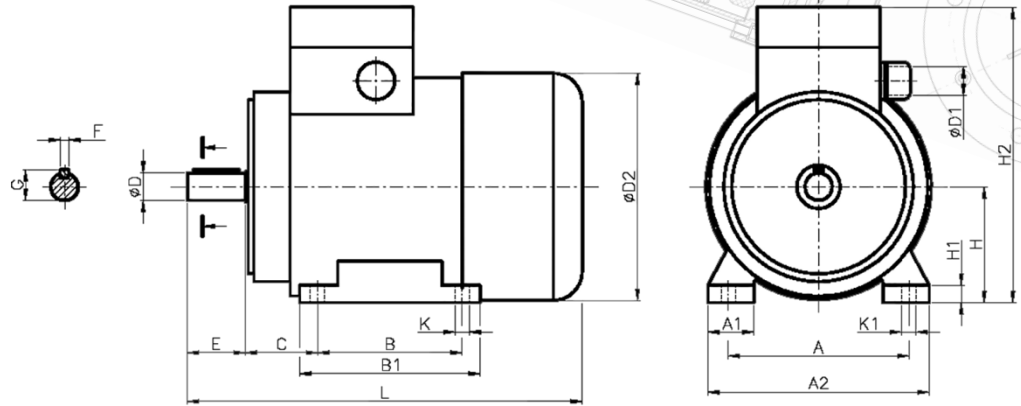

Type of construction	Dimensions [mm]																		
	A	A1	A2	B	B1	C	ØD	ØD1	ØD2	E	F	G	H	H1	H2	K	K1	L	Bearing
SSg90-S IMB3	140	43	176	100	130	56	24j6	M25	179	50	8h9	27	90	15	224	10	17	305	6205
SSg90-L IMB3				125	155													330	

**Dimensional drawing – flange mounting SSKg90
IMB5, IMB14/1, IMB14/2**

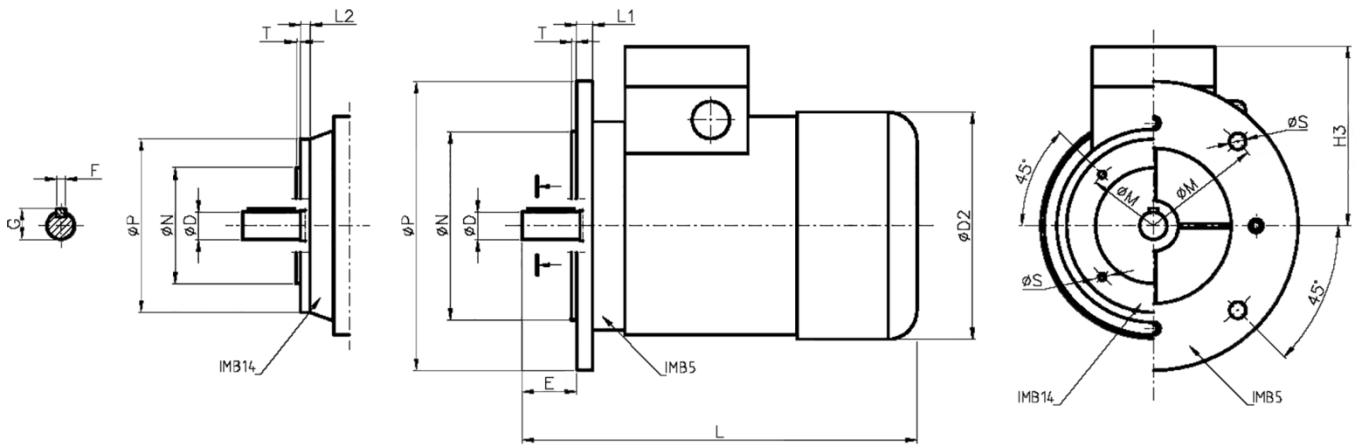

Type of construction	Dimensions [mm]															
	ØD	ØD1	ØD2	E	F	G	H3	L	L1	L2	ØM	ØN	ØP	ØS	T	Bearing
SSKg90-S IMB5	24j6	M25	179	50	8h9	27	134	305	10,5	-	165	130j6	200	12	3,5	6205
SSKg90-L IMB5								330								
SSKg90-S IMB14/1								305	-	9,5	130	110j6	160	M8		
SSKg90-L IMB14/1								330								
SSg90-S IMB14/2								305	-	14,5	115	95j6	140	M8	3	
SSg90-L IMB14/2								330								

