

ONE-PHASE MOTORS FOR VOLTAGE REGULATION Series SSg80

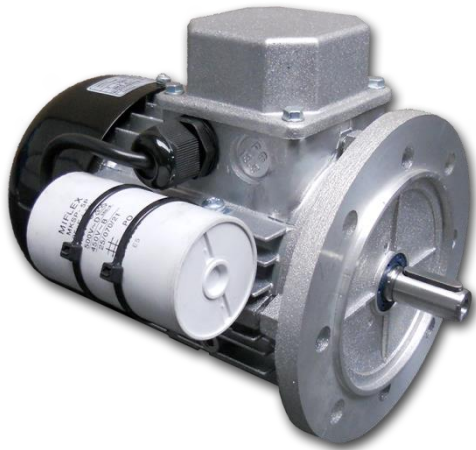

General technical date:

- Single phases induction motors
- Frame size 80
- Rated voltage 230V / 50Hz
- Full temperature protection: bimetallic sensor in stand Winding
- Duty S1 (continuous work)
- Insulation class F
- Degree of protection IP54 (to IP55 on request)
- Work in moderate climate conditions (ambient temperature from -15°C to +40°C)
- Aluminium frame
- Motors meet requirements of EN 60034-1
- CE certificate

Silniki 2-biegunowe (3000 min⁻¹) i 4-biegunowe (1500 min⁻¹)

Type	Rated Output P ₂ [kW]	Rated speed ω [min ⁻¹]	Rated current at 230 V I _N [A]	Rel. pull-in current I _R /I _N	Rated torque M _N [Nm]	Rel. starting torque M _R /M _N	Capacitor C [μF]	Power factor cos φ	Efficiency η [%]
SSg80-2A	0,55	2870	3,40	4,37	1,81	0,48	50	0,99	73
SSg80-2B	0,75	2840	4,50	3,78	2,52	0,48	50	0,99	74
SSg80-2C	1,1	2880	6,40	4,22	3,61	0,50	100	0,97	78
SSg80-4A	0,37	1420	2,50	3,22	2,49	0,53	40	0,97	68
SSg80-4B	0,55	1440	3,60	3,55	3,65	0,52	60	0,94	73
SSg80-4C	0,75	1430	4,50	4,40	5,01	0,50	70	0,96	78

6-poles Motors (1000 rpm) and 8-poles Motors (750 rpm) – on request

Single-phase induction motors of the SSg series are intended for the drive of loads, in which the increase of the motor load takes place along with the square of its rotational speed. This is called fan load characteristic $M_o = f(\omega^2)$, occurring in axial and radial fans and other types of devices for continuous transport of gases or liquids.

Due to the continuous development of the product, the manufacturer reserves the right to introduce changes and modifications to the technical data without prior notice





**Dimensional drawing – feet mounting SSg80
IMB3**

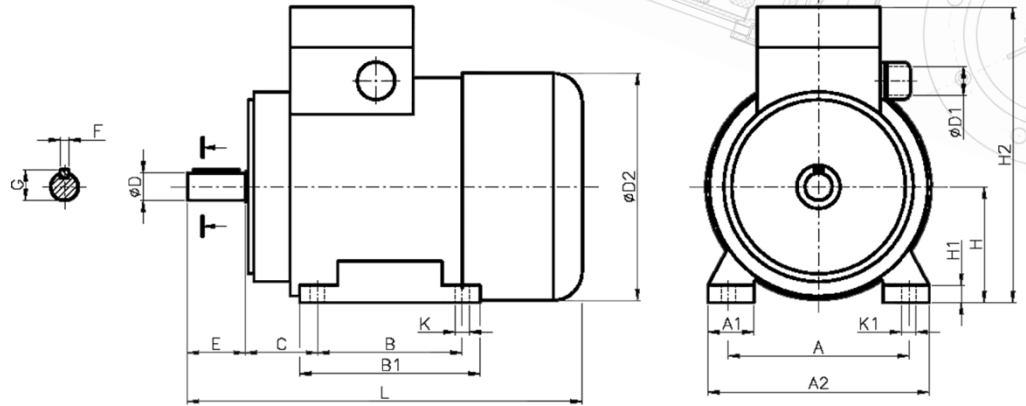

Type of construction	Dimensions [mm]																		
	A	A1	A2	B	B1	C	ØD	ØD1	ØD2	E	F	G	H	H1	H2	K	K1	L	Bearing
SSg80 IMB3	125	33	154	100	125	50	19j6	M20	162	40	6h9	21,5	80	15	213	9	16	277	6204 ZZ

**Dimensional drawing – flange mounting SSKg80
IMB5
IMB14/1
IMB14/2**

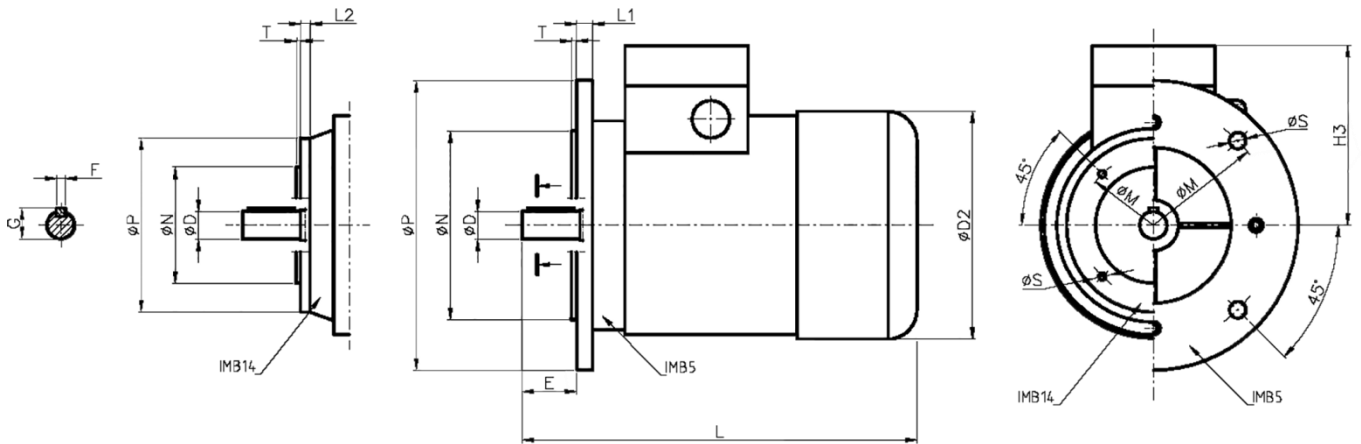

Type of construction	Dimensions [mm]															
	ØD	ØD1	ØD2	E	F	G	H3	L	L1	L2	ØM	ØN	ØP	ØS	T	Bearing
SSKg80 IMB5	19j6	M20	162	40	6h9	21,5	133	277	10	-	165	130j6	200	12	3,5	6204 ZZ
SSKg80 IMB14/1									-	9,5	130	110j6	160	M8		
SSKg80 IMB14/2									-	11	100	80j6	120	M6		

