

## ONE-PHASE MOTORS FOR VOLTAGE REGULATION Series SSg71

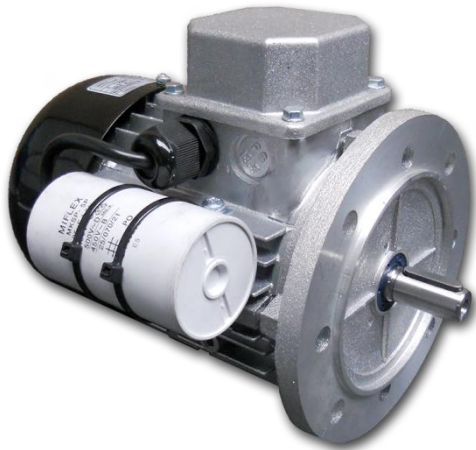

### General technical date:

- Single phases induction motors
- Frame size 71
- Rated voltage 230V / 50Hz
- Full temperature protection: bimetallic sensor in stand Winding
- Duty S1 (continuous work)
- Insulation class F
- Degree of protection IP54 (to IP55 on request)
- Work in moderate climate conditions (ambient temperature from -15°C to +40°C)
- Aluminium frame
- Motors meet requirements of EN 60034-1
- CE certificate

### Silniki 2-biegunowe (3000 min<sup>-1</sup>) i 4-biegunowe (1500 min<sup>-1</sup>)

Type	Rated Output P <sub>2</sub> [kW]	Rated speed ω [min <sup>-1</sup> ]	Rated current at 230 V I <sub>N</sub> [A]	Rel. pull-in current I <sub>R</sub> /I <sub>N</sub>	Rated torque M <sub>N</sub> [Nm]	Rel. starting torque M <sub>R</sub> /M <sub>N</sub>	Capacitor C [μF]	Power factor cos φ	Efficiency η [%]
SSg71-2A	0,25	2880	1,80	4,93	0,83	0,50	25	0,99	62
SSg71-2B	0,37	2890	2,30	5,47	1,22	0,46	35	0,99	70
SSg71-2C	0,55	2850	3,15	4,30	1,84	0,38	40	0,99	77
SSg71-4A	0,18	1420	1,50	2,85	1,21	0,47	18	0,84	62
SSg71-4B	0,25	1420	1,80	2,82	1,68	0,60	30	0,92	64
SSg71-4C	0,37	1420	2,50	3,28	2,49	0,49	40	0,95	70
SSg71-4D	0,55	1430	3,80	3,52	3,67	0,45	60	0,92	71

### 6-poles Motors (1000 rpm) and 8-poles Motors (750 rpm) – on request

Single-phase induction motors of the SSg series are intended for the drive of loads, in which the increase of the motor load takes place along with the square of its rotational speed. This is called fan load characteristic  $M_o = f(\omega^2)$ , occurring in axial and radial fans and other types of devices for continuous transport of gases or liquids.

Due to the continuous development of the product, the manufacturer reserves the right to introduce changes and modifications to the technical data without prior notice





**Dimensional drawing – feet mounting SSg71  
IMB3**

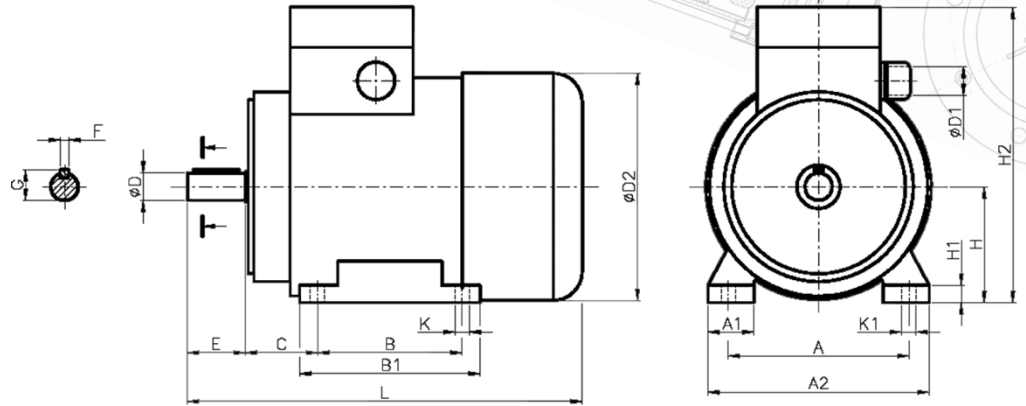

Type of construction	Dimensions [mm]																		
	A	A1	A2	B	B1	C	ØD	ØD1	ØD2	E	F	G	H	H1	H2	K	K1	L	Bearing
SSg71 IMB3	112	30	137	90	108	45	14j6	M20	144	30	5h9	16	71	13	208	7	12	241	6003

**Dimensional drawing – flange mounting SSKg71  
IMB5  
IMB14/1  
IMB14/2**

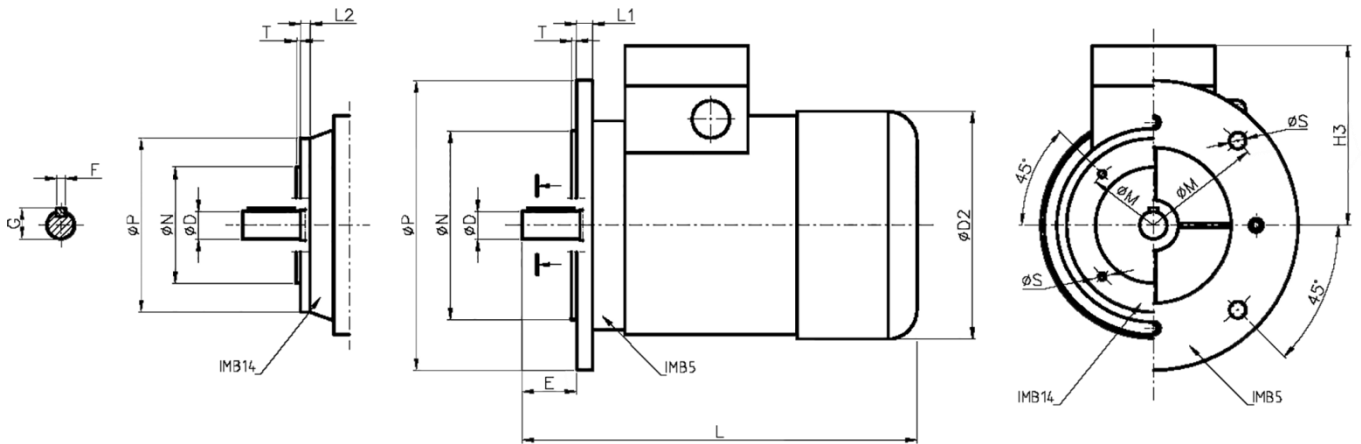

Type of construction	Dimensions [mm]															
	ØD	ØD1	ØD2	E	F	G	H3	L	L1	L2	ØM	ØN	ØP	ØS	T	Bearing
SSKg71 IMB5									10	-	130	110j6	160	10	3,5	6003
SSKg71 IMB14/1	14j6	M20	144	30	5h9	16	137	241	-	11	115	95j6	140	M8	3	
SSKg71 IMB14/2									-	11,5	85	70j6	105	M6	2,5	

