

ONE-PHASE MOTORS FOR VOLTAGE REGULATION Series SSg63

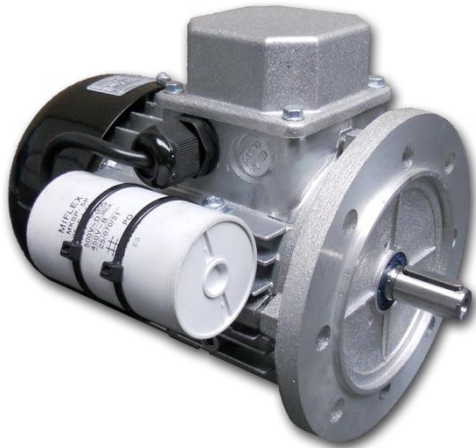

General technical date:

- Single phases induction motors
- Frame size 63
- Rated voltage 230V / 50Hz
- Full temperature protection:
bimetallic sensor in stand Winding
- Duty S1 (continuous work)
- Insulation class F
- Degree of protection IP54 (to IP55 on request)
- Work in moderate climate conditions
(ambient temperature from -15°C to +40°C)
- Aluminium frame
- Motors meet requirements of EN 60034-1
- CE certificate

Silniki 2-biegunowe (3000 min⁻¹) i 4-biegunowe (1500 min⁻¹)

Type	Rated Output P ₂ [kW]	Rated speed ω [min ⁻¹]	Rated current at 230 V I _N [A]	Rel. pull-in current I _R /I _N	Rated torque M _N [Nm]	Rel. starting torque M _R /M _N	Capacitor C [μF]	Power factor cos φ	Efficiency η [%]
SSg63-2A	0,12	2800	1,00	3,25	0,41	0,50	12	0,99	56
SSg63-2B	0,18	2800	1,40	3,30	0,61	0,40	16	0,98	62
SSg63-2C	0,25	2850	2,00	3,76	0,84	0,53	25	0,84	62
SSg63-4A	0,09	1410	1,00	2,30	0,61	0,52	12	0,77	51
SSg63-4B	0,12	1410	1,10	2,70	0,81	0,64	14	0,81	59
SSg63-4C	0,18	1390	2,10	2,00	1,24	0,38	14	0,72	56

6-poles Motors (1000 rpm) and 8-poles Motors (750 rpm) – on request

Single-phase induction motors of the SSg series are intended for the drive of loads, in which the increase of the motor load takes place along with the square of its rotational speed. This is called fan load characteristic $M_o = f(\omega^2)$, occurring in axial and radial fans and other types of devices for continuous transport of gases or liquids.

Due to the continuous development of the product, the manufacturer reserves the right to introduce changes and modifications to the technical data without prior notice





**Dimensional drawing – feet mounting SSg63
IMB3**

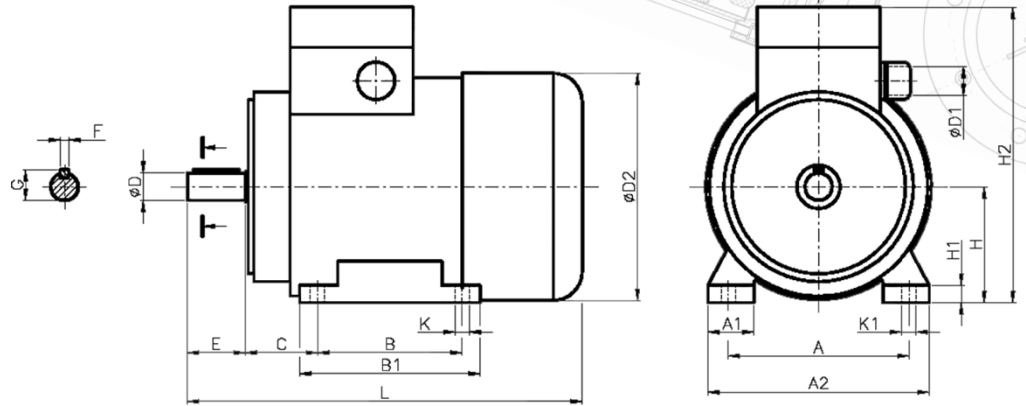

Type of construction	Dimensions [mm]																		
	A	A1	A2	B	B1	C	ØD	ØD1	ØD2	E	F	G	H	H1	H2	K	K1	L	Bearing
SSg63 IMB3	100	23	120	80	105	40	11j6	M20	127	23	4h9	12,5	63	10	189	7	12	211	6202 Z2

**Dimensional drawing – flange mounting SSKg63
IMB5
IMB14/1
IMB14/2**

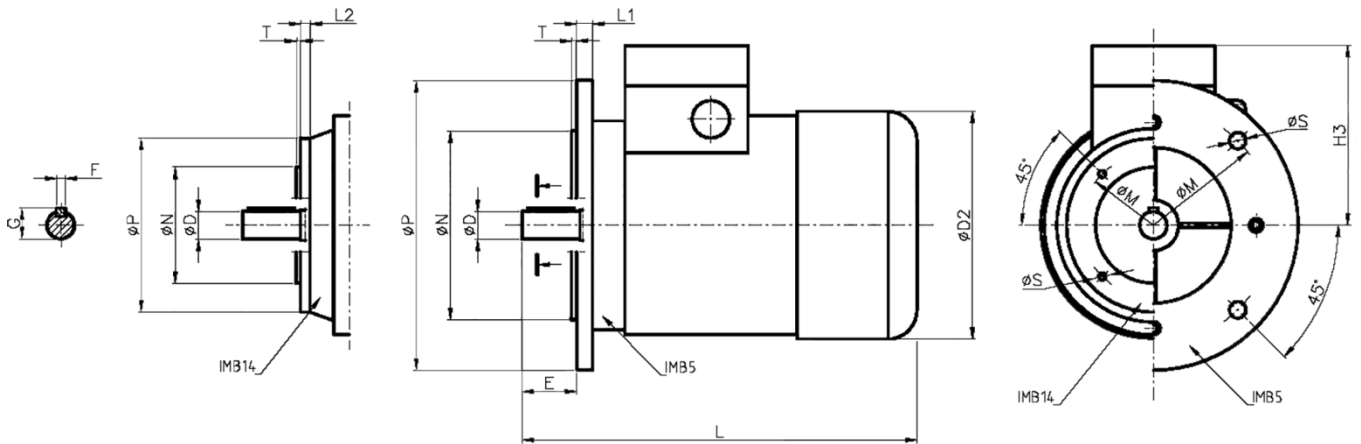

Type of construction	Dimensions [mm]															
	ØD	ØD1	ØD2	E	F	G	H3	L	L1	L2	ØM	ØN	ØP	ØS	T	Bearing
SSKg63 IMB5	11j6	M20	127	23	4h9	12,5	126	211	10	-	115	95j6	140	10	3	6202 Z2
SSKg63 IMB14/1									-	8	100	80j6	120	M6		
SSKg63 IMB14/2									-	7	75	60j6	90	M5		

