

THREE-PHASE MOTORS FOR GENERAL PURPOSE Series Sg90

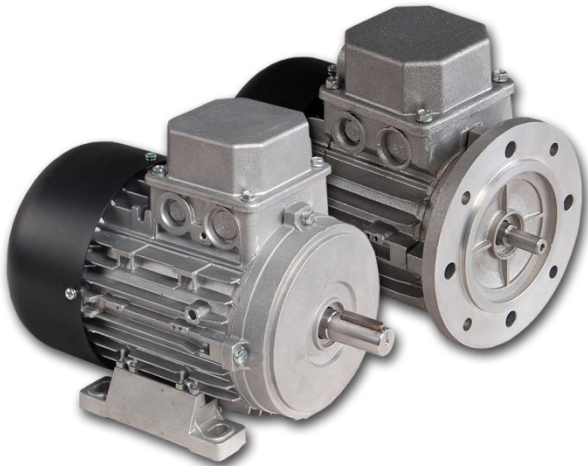

General technical date:

- Three phases induction motors
- Frame size 90
- Rated voltage 230/400V (Δ/Y) / 50Hz
- Full temperature protection:
bimetallic sensor in stand Winding
- Duty S1 (continuous work)
- Insulation class F
- Degree of protection IP54 (to IP55 on request)
- Work in moderate climate conditions
(ambient temperature from -15°C to $+40^{\circ}\text{C}$)
- Aluminium frame
- Motors meet requirements of EN 60034-1
- CE certificate

2-poles Motors (3000 rpm)

Type	Rated Output P_2 [kW]	Rated speed ω [min^{-1}]	Rated current at I_N [A]		Rel. pull-in current I_R/I_N	Rated torque M_N [Nm]	Rel. starting torque M_R/M_N	Efficiency η [%]
			230 V Δ	400 V Y				
Sg90-2S	1,5	2800	5,72	3,30	5,45	5,11	2,93	81 ⁽²⁾
Sg90-2L	2,2	2830	8,31	4,80	7,08	7,42	3,49	84 ⁽²⁾

⁽²⁾ klasa sprawności IE2

4-poles Motors (1500 rpm)

Type	Rated Output P_2 [kW]	Rated speed ω [min^{-1}]	Rated current at I_N [A]		Rel. pull-in current I_R/I_N	Rated torque M_N [Nm]	Rel. starting torque M_R/M_N	Efficiency η [%]
			230 V Δ	400 V Y				
Sg90-4S	1,1	1410	5,02	2,90	4,40	7,45	2,42	88 ⁽³⁾
Sg90-4L	1,5	1420	6,15	3,55	4,87	10,10	2,61	91 ⁽³⁾

⁽³⁾ klasa sprawności IE3

6-poles Motors (1000 rpm) and 8-poles Motors (750 rpm) – on request

Due to the continuous development of the product, the manufacturer reserves the right to introduce changes and modifications to the technical data without prior notice





**Dimensional drawing – feet mounting Sg90
IMB3**

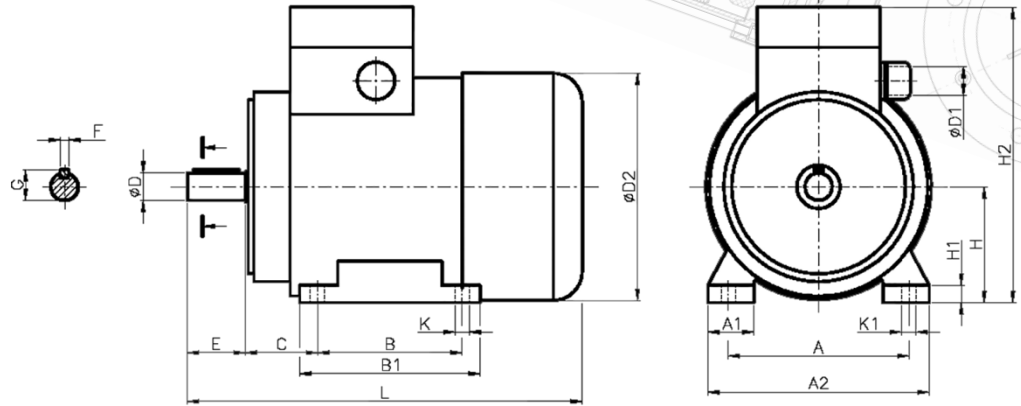

Type of construction	Dimensions [mm]																		
	A	A1	A2	B	B1	C	ØD	ØD1	ØD2	E	F	G	H	H1	H2	K	K1	L	Bearing
Sg90-S IMB3	140	43	176	100	130	56	24j6	M25	179	50	8h9	27	90	15	219	10	17	305	6205
Sg90-L IMB3				125	155													330	

**Dimensional drawing – flange mounting SKg90
IMB5, IMB14/1, IMB14/2**

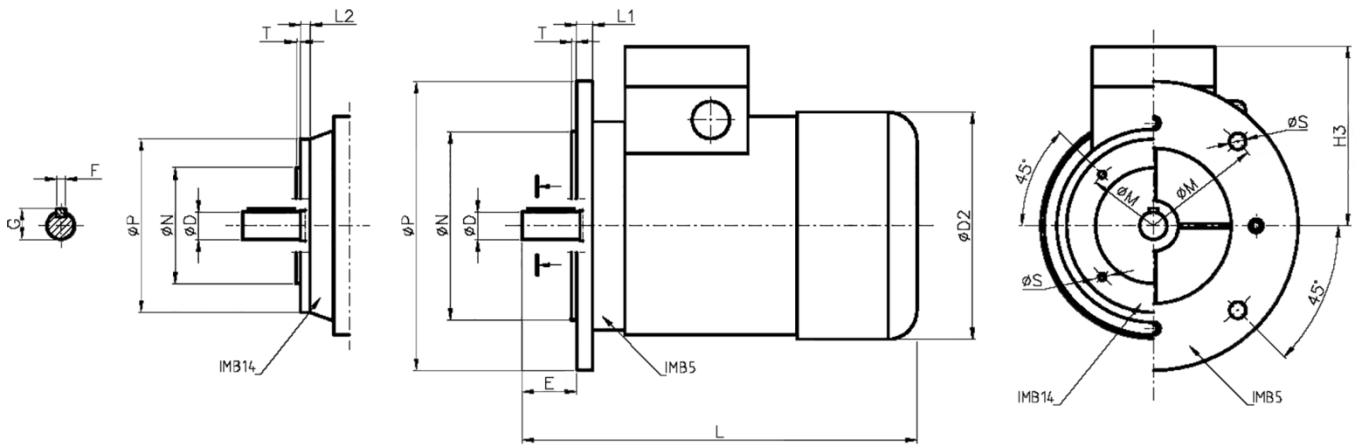

Type of construction	Dimensions [mm]															
	ØD	ØD1	ØD2	E	F	G	H3	L	L1	L2	ØM	ØN	ØP	ØS	T	Bearing
SKg90-S IMB5	24j6	M25	179	50	8h9	27	129	305	10,5	-	165	130j6	200	12	3,5	6205
SE(M)Kg90-L IMB5								330								
SKg90-S IMB14/1								-	9,5	130	110j6	160	M8			
SKg90-L IMB14/1								330								
SKg90-S IMB14/2								305	-	14,5	115	95j6	140	M8	3	
SKg90-L IMB14/2								330								

