

THREE-PHASE MOTORS FOR GENERAL PURPOSE Series Sg80

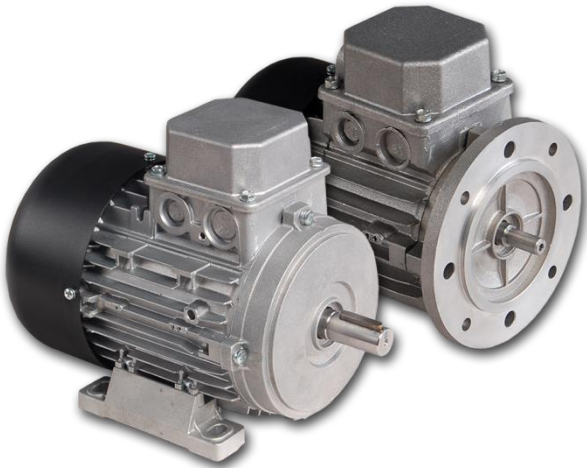

General technical date:

- Three phases induction motors
- Frame size 80
- Rated voltage 230/400V (Δ/Y) / 50Hz
- Full temperature protection:
bimetallic sensor in stand Winding
- Duty S1 (continuous work)
- Insulation class F
- Degree of protection IP54 (to IP55 on request)
- Work in moderate climate conditions
(ambient temperature from -15°C to $+40^{\circ}\text{C}$)
- Aluminium frame
- Motors meet requirements of EN 60034-1
- CE certificate

2-poles Motors (3000 rpm)

Type	Rated Output P_2 [kW]	Rated speed ω [min $^{-1}$]	Rated current at I_N [A]		Rel. pull-in current I_r/I_N	Rated torque M_N [Nm]	Rel. starting torque M_r/M_N	Efficiency η [%]
			230 V Δ	400 V Y				
Sg80-2A	0,75	2810	3,29	1,90	5,79	2,55	3,85	79 ⁽²⁾
Sg80-2B	1,1	2800	4,21	2,43	5,14	3,75	3,02	80 ⁽²⁾
Sg80-2C	1,5	2830	5,54	3,20	6,56	5,06	3,68	86 ⁽³⁾

⁽²⁾ klasa sprawności IE2

⁽³⁾ klasa sprawności IE3

4-poles Motors (1500 rpm)

Type	Rated Output P_2 [kW]	Rated speed ω [min $^{-1}$]	Rated current at I_N [A]		Rel. pull-in current I_r/I_N	Rated torque M_N [Nm]	Rel. starting torque M_r/M_N	Efficiency η [%]
			230 V Δ	400 V Y				
Sg80-4A	0,55	1380	2,77	1,60	3,50	3,80	2,38	74
Sg80-4B	0,75	1410	3,81	2,20	4,49	5,08	2,79	80 ⁽²⁾
Sg80-4C	1,1	1380	4,68	2,70	4,07	7,61	2,45	86 ⁽³⁾

⁽²⁾ klasa sprawności IE2

⁽³⁾ klasa sprawności IE3

6-poles Motors (1000 rpm) and 8-poles Motors (750 rpm) – on request

Due to the continuous development of the product, the manufacturer reserves the right to introduce changes and modifications to the technical data without prior notice





**Dimensional drawing – feet mounting Sg80
IMB3**

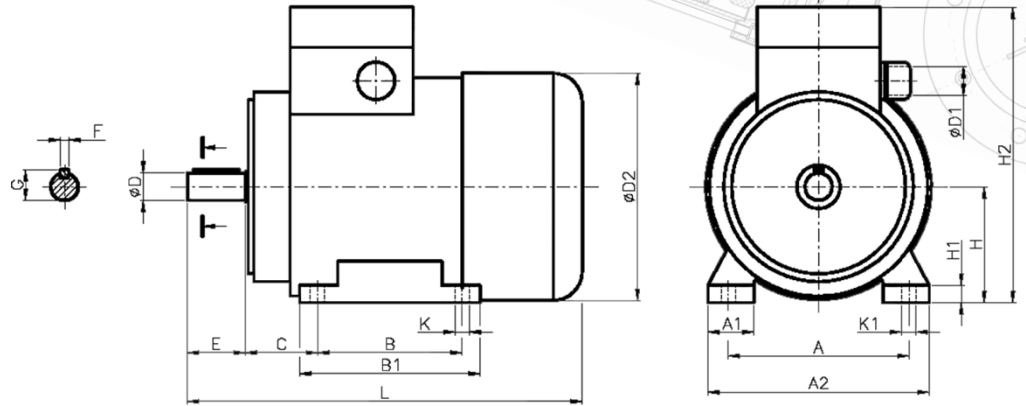

Type of construction	Dimensions [mm]																		
	A	A1	A2	B	B1	C	ØD	ØD1	ØD2	E	F	G	H	H1	H2	K	K1	L	Bearing
Sg80 IMB3	125	33	154	100	125	50	19j6	M20	162	40	6h9	21,5	80	15	205	9	16	277	6204 ZZ

**Dimensional drawing – flange mounting SKg80
IMB5
IMB14/1
IMB14/2**

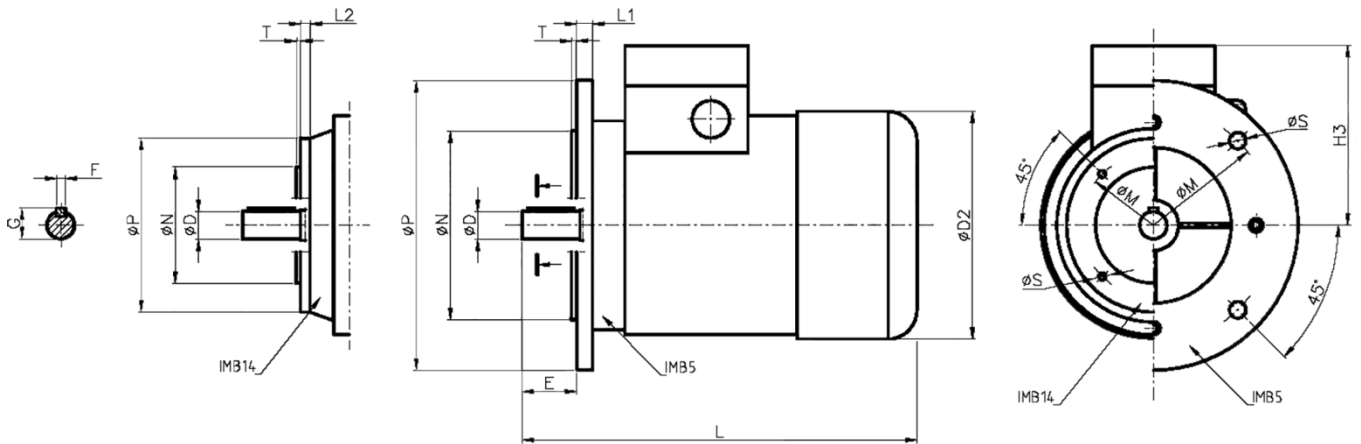

Type of construction	Dimensions [mm]															
	ØD	ØD1	ØD2	E	F	G	H3	L	L1	L2	ØM	ØN	ØP	ØS	T	Bearing
SKg80 IMB5	19j6	M20	162	40	6h9	21,5	125	277	10	-	165	130j6	200	12	3,5	6204 ZZ
SKg80 IMB14/1									-	9,5	130	110j6	160	M8		
SKg80 IMB14/2									-	11	100	80j6	120	M6		

