

## THREE-PHASE MOTORS FOR GENERAL PURPOSE Series Sg71

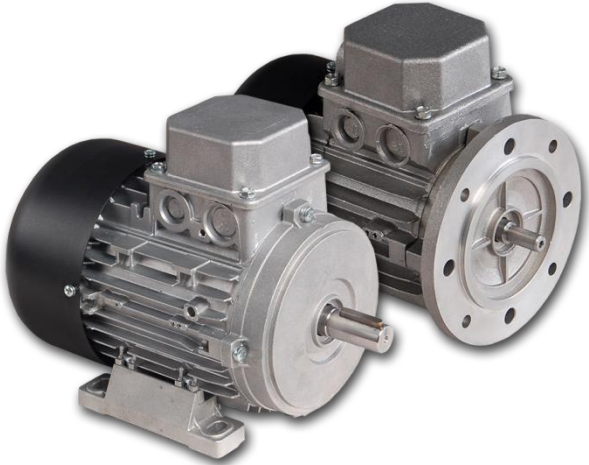

### General technical date:

- Three phases induction motors
- Frame size 71
- Rated voltage 230/400V ( $\Delta/Y$ ) / 50Hz
- Full temperature protection:  
bimetallic sensor in stand Winding
- Duty S1 (continuous work)
- Insulation class F
- Degree of protection IP54 (to IP55 on request)
- Work in moderate climate conditions  
(ambient temperature from  $-15^{\circ}\text{C}$  to  $+40^{\circ}\text{C}$ )
- Aluminium frame
- Motors meet requirements of EN 60034-1
- CE certificate

### 2-poles Motors (3000 rpm)

Type	Rated Output $P_2$ [kW]	Rated speed $\omega$ [min $^{-1}$ ]	Rated current at $I_N$ [A]		Rel. pull-in current $I_R/I_N$	Rated torque $M_N$ [Nm]	Rel. starting torque $M_R/M_N$	Efficiency $\eta$ [%]
			230 V $\Delta$	400 V $Y$				
Sg71-2A	0,37	2830	1,82	1,05	5,71	1,25	3,73	70
Sg71-2B	0,55	2840	2,42	1,40	5,87	1,85	3,90	77
Sg71-2C	0,75	2810	2,94	1,70	5,26	2,55	3,19	82 <sup>(3)</sup>

<sup>(3)</sup> klasa sprawności IE3

### 4-poles Motors (1500 rpm)

Type	Rated Output $P_2$ [kW]	Rated speed $\omega$ [min $^{-1}$ ]	Rated current at $I_N$ [A]		Rel. pull-in current $I_R/I_N$	Rated torque $M_N$ [Nm]	Rel. starting torque $M_R/M_N$	Efficiency $\eta$ [%]
			230 V $\Delta$	400 V $Y$				
Sg71-4A	0,25	1390	1,56	0,90	3,33	1,72	2,50	65
Sg71-4B	0,37	1360	2,08	1,20	3,00	2,60	2,01	73
Sg71-4C	0,55	1380	2,77	1,60	3,94	3,80	2,65	78
Sg71-4D	0,75	1400	3,81	2,20	4,40	5,10	2,78	80 <sup>(2)</sup>

<sup>(2)</sup> klasa sprawności IE2

### 6-poles Motors (1000 rpm) and 8-poles Motors (750 rpm) – on request

Due to the continuous development of the product, the manufacturer reserves the right to introduce changes and modifications to the technical data without prior notice





**Dimensional drawing – feet mounting Sg71  
IMB3**

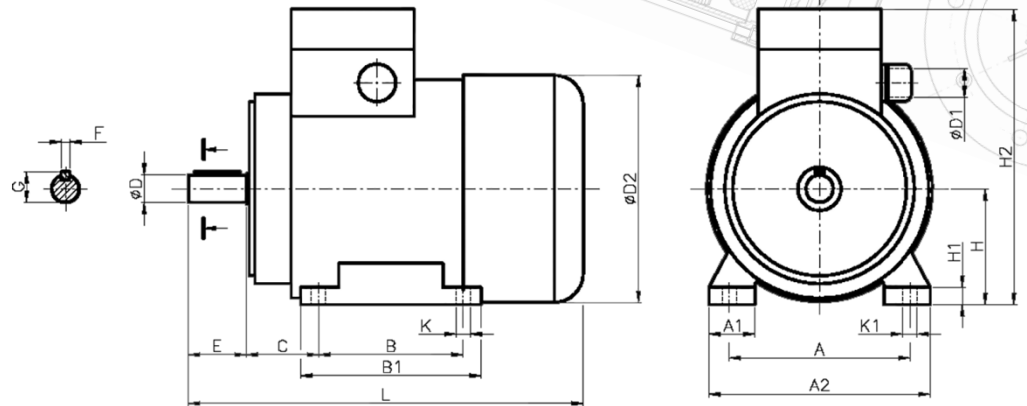

Type of construction	Dimensions [mm]																		
	A	A1	A2	B	B1	C	ØD	ØD1	ØD2	E	F	G	H	H1	H2	K	K1	L	Bearing
Sg71 IMB3	112	30	137	90	108	45	14j6	M20	144	30	5h9	16	71	13	181	7	12	241	6003

**Dimensional drawing – flange mounting SKg71  
IMB5  
IMB14/1  
IMB14/2**

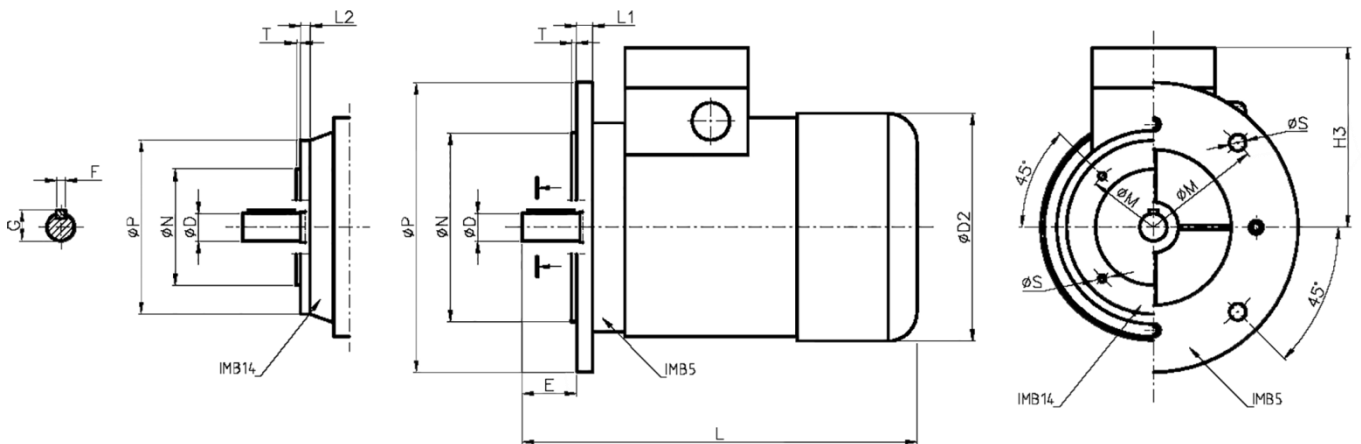

Type of construction	Dimensions [mm]															
	ØD	ØD1	ØD2	E	F	G	H3	L	L1	L2	ØM	ØN	ØP	ØS	T	Bearing
SKg71 IMB5									10	-	130	110j6	160	10	3,5	6003
SKg71 IMB14/1	14j6	M20	144	30	5h9	16	110	241	-	11	115	95j6	140	M8	3	
SKg71 IMB14/2									-	11,5	85	70j6	105	M6	2,5	

