

THREE-PHASE MOTORS FOR GENERAL PURPOSE Series Sg63

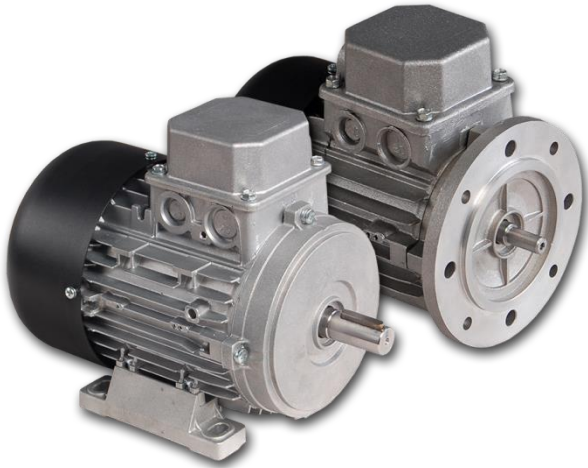

General technical date:

- Three phases induction motors
- Frame size 63
- Rated voltage 230/400V (Δ/Y) / 50Hz
- Full temperature protection:
bimetallic sensor in stand Winding
- Duty S1 (continuous work)
- Insulation class F
- Degree of protection IP54 (to IP55 on request)
- Work in moderate climate conditions
(ambient temperature from -15°C to $+40^{\circ}\text{C}$)
- Aluminium frame
- Motors meet requirements of EN 60034-1
- CE certificate

2-poles Motors (3000 rpm)

Type	Rated Output P_2 [kW]	Rated speed ω [min^{-1}]	Rated current at I_N [A]		Rel. pull-in current I_R/I_N	Rated torque M_N [Nm]	Rel. starting torque M_R/M_N	Efficiency η [%]
			230 V Δ	400 V Y				
Sg63-2A	0,18	2750	0,95	0,55	4,10	0,63	3,08	64
Sg63-2B	0,25	2750	1,21	0,70	4,70	0,87	3,24	66
Sg63-2C	0,37	2790	2,25	1,30	3,85	1,27	4,25	66

4-poles Motors (1500 rpm)

Type	Rated Output P_2 [kW]	Rated speed ω [min^{-1}]	Rated current at I_N [A]		Rel. pull-in current I_R/I_N	Rated torque M_N [Nm]	Rel. starting torque M_R/M_N	Efficiency η [%]
			230 V Δ	400 V Y				
Sg63-4A	0,12	1380	1,04	0,60	2,40	0,83	2,40	55
Sg63-4B	0,18	1370	1,21	0,70	2,50	1,25	2,50	60
Sg63-4C	0,25	1380	2,08	1,20	2,82	1,74	3,43	60

6-poles Motors (1000 rpm) and 8-poles Motors (750 rpm) – on request

Due to the continuous development of the product, the manufacturer reserves the right to introduce changes and modifications to the technical data without prior notice





**Dimensional drawing – feet mounting Sg63
IMB3**

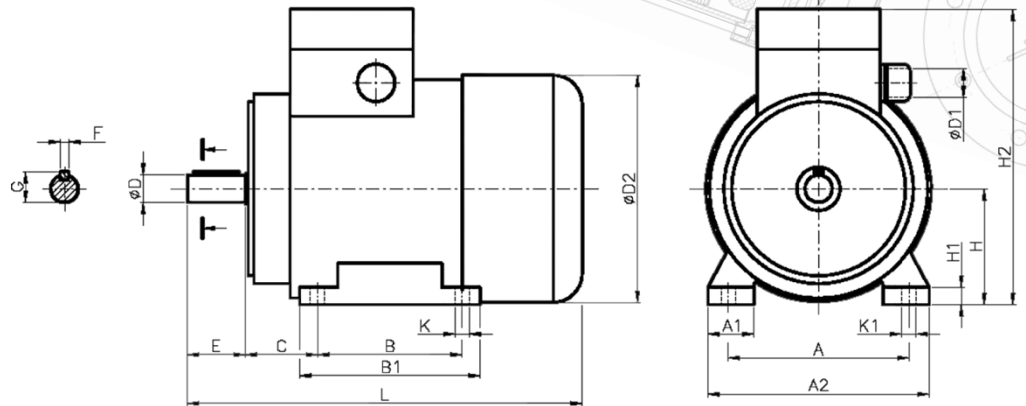

Type of construction	Dimensions [mm]																		
	A	A1	A2	B	B1	C	ØD	ØD1	ØD2	E	F	G	H	H1	H2	K	K1	L	Bearing
Sg63 IMB3	100	23	120	80	105	40	11j6	M20	127	23	4h9	12,5	63	10	162	7	12	211	6202 Z2

**Dimensional drawing – flange mounting SKg63
IMB5
IMB14/1
IMB14/2**

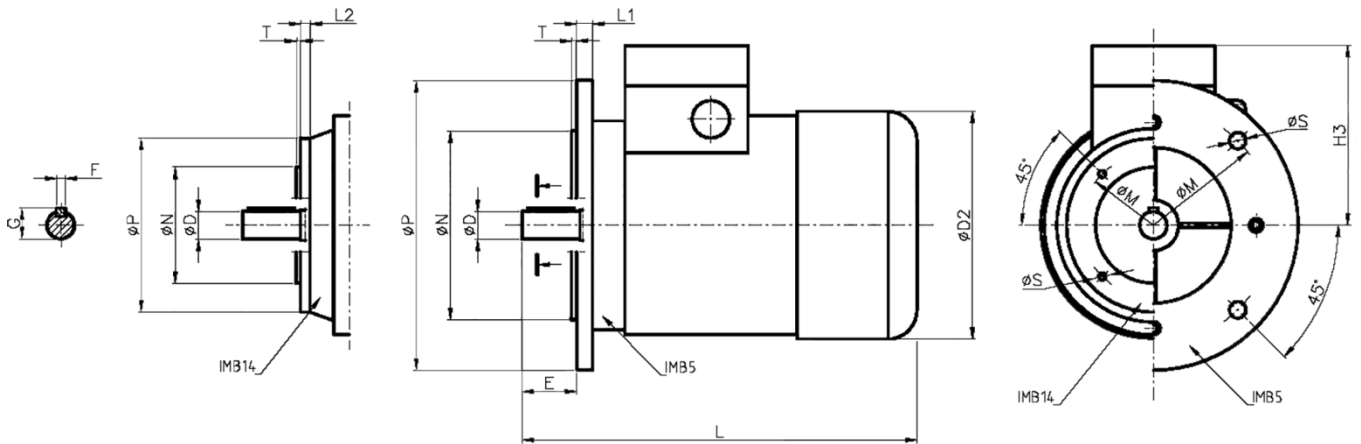

Type of construction	Dimensions [mm]															
	ØD	ØD1	ØD2	E	F	G	H3	L	L1	L2	ØM	ØN	ØP	ØS	T	Bearing
SKg63 IMB5	11j6	M20	127	23	4h9	12,5	99	211	10	-	115	95j6	140	10	3	6202 Z2
SKg63 IMB14/1									-	8	100	80j6	120	M6		
SKg63 IMB14/2									-	7	75	60j6	90	M5		

